

# BUTTERFLY VALVE U TYPE

## FAF3800U

3800U



### Features

- PTFE bushing ensure the maximum shaft support.
- 360° polished disc assures positive on-off.
- Hard-backed cartridge seat.
- Universal ISO5211 mounting pad.
- Flow curve tending to straight line. Excellent regulation performance.
- Bubble-tight sealing with no leakage under pressure test.
- Wide selection of materials, applicable for various mediums.
- Higher thicknesses are available upon request.
- Stem sealing is not easy deformation, so avoids leakage phenomenon.
- Overall support is good, stable and solid.
- Use less rubber of seat, so expansion has small impact and easy to control torque value at an appropriate range.
- Applying to two pieces of no-sells connection; structure is simple and convenient to be maintained.
- Butterfly disc owns automatic alignment function and achieved small combination of disc and seat.
- Phenolic back seat is featured such as no loss, tensile, anti-leak, convenient replacement etc.
- For seat sealing surface and phenolic back as whole as a whole, it can reduce amount of deformation.
- Long service life.

### Temperature

- +130 °C (EPDM)
- +100 °C (NBR)

### PRODUCTION STANDARDS

DN40 → DN2000  
PN 10-16

Design	EN 593
Connection	EN 1092-2 ISO 7005-2 Flanged
End Connection	EN 558 Series 20
Marking	EN 19
Tests	EN 12266-1
Corrosion Protection	Electrostatic Powder Epoxy WRAS Approved (Optional)

### Product Description

FAF3800U U-Type Flanged Butterfly Valve is resilient-seated in double-flange design with centric bearing disc. The valve simple and compact construction, quick 90° on-off operation. Has simple structure; good interchangeability and low price.

### Versions

- Standard version with gearbox
- Prepared for electrical actuator
- With electrical actuator
- Custom production for specific orders

### Accessories

- T-key, FAF7250
- Extension spindle, ST steel, FAF3790
- Surface box, cast iron, FAF3790
- Position indicator
- Flange adaptors, FAF3960
- Dismantling joints, FAF3900
- Handwheel

### Scope of Application

- Chamber installation
- Installation in plants
- Pipelines
- Water treatment plants
- Pumping stations
- Tanks
- Seawater applications
- Power plants (cooling water pipelines)
- Industry

# BUTTERFLY VALVE U TYPE

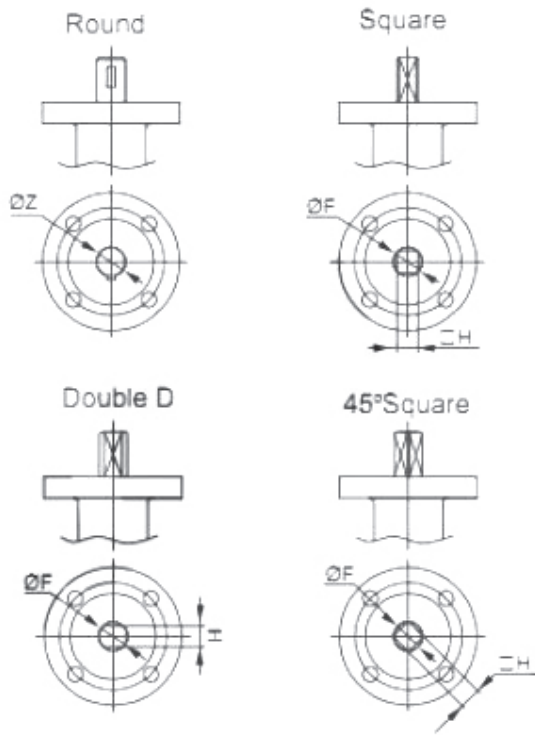

### MATERIAL SELECTION

<b>Body</b>	EN-GJL-250 Cast Iron / GG25 EN-GJS-400 Ductile Iron / GGG40
<b>Disc</b>	A351 CF8M Stainless Steel EN-GJS-400 Ductile Iron / GGG40
<b>Stem</b>	1.4401 - AISI 316 Stainless Steel 1.4021 - AISI 420 Stainless Steel
<b>Sealing</b>	EPDM NBR

### VALVE TEST PRESSURE (Bar)

MAX. OPERATING PRESSURE	BODY / SHELL TEST	SEAT TEST
10	15	11
16	24	17,6

100% of the valves are subjected to hydrostatic tests at FAF facilities.

### Note

- For proper use and safety precautions please follow the installation and operating instructions.

### Material List

NO	ITEM	MATERIALS
1	BODY	EN-GJL-250 CAST IRON
2	DISC	A351 CF8M STAINLESS STEEL
3	STEM	1.4401 - AISI 316 STAINLESS STEEL
4	SEAT	EPDM
5	BUSHING	PTFE
6	O-RING	EPDM
7	PIN	A351 CF8M STAINLESS STEEL

## BUTTERFLY VALVE U TYPE FAF3800U



### Technical Details & Drawing, Dimensions

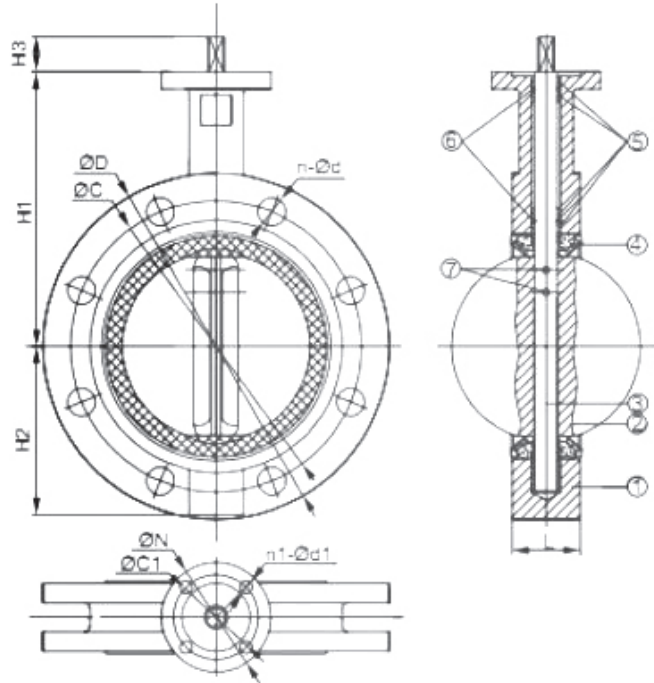

Size		L	H1	H2	H3	ISO5211				DIN2501 PN16			φZ	φF	H
DN	NPS					TOP	φN	ΦC1	n1-φd1	ΦD	φC	n-φd			
40	1.5"	33	139	75	29	F05	65	50	4-φ8	150	110	4-φ18	12.6	12.1	9
50	2"	43	161	82.5	29	F05	65	50	4-φ8	165	125	4-φ18	12.6	12.1	9
65	2-1/2"	46	175	92.5	29	F05	65	50	4-φ8	185	145	4-φ18	12.6	12.1	9
80	3"	46	181	100	29	F05	65	50	4-φ8	200	160	8-φ18	12.6	12.1	9
100	4"	52	200	110	29	F07	90	70	4-φ10	220	180	8-φ18	15.77	14.1	11
125	5"	56	213	125	29	F07	90	70	4-φ10	250	210	8-φ18	18.92	18.1	14
150	6"	56	226	142.5	29	F07	90	70	4-φ10	285	240	8-φ22	18.92	18.1	14
200	8"	60	260	170	35	F010	125	102	4-φ12	340	295	12-φ22	22.1	22.2	17
250	10"	68	292	202.5	35	F010	125	102	4-φ12	405	355	12-φ26	28.45	28.2	22
300	12"	78	337	230	35	F010	125	102	4-φ12	460	410	12-φ26	31.6	28.2	22
350	14"	78	368	260	45	F010	125	102	4-φ12	520	470	16-φ26	31.6	28.2	22
400	16"	102	400	290	51.2	F014	175	140	4-φ18	580	525	16-φ30	33.15	28.2	22
450	18"	114	422	324	51.2	F014	175	140	4-φ18	640	585	20-φ30	38	36.2	27
500	20"	127	480	357.5	64.2	F014	175	140	4-φ18	715	650	20-φ33	41.15	36.2	27
550	22"	154	537	378	70.2	F016	210	165	4-φ22	N/A	N/A	N/A	50.65	48.2	36
600	24"	154	562	420	70.2	F016	210	165	4-φ22	840	770	20-φ36	50.65	48.2	36

Size		L	H1	H2	H3	ISO5211				DIN2501 PN10			φZ	φF	H
DN	NPS					TOP	φN	ΦC1	n1-Φd1	ΦD	ΦC	n-Φd			
700	28"	165	624	455	85	F25	300	254	8-φ18	895	840	24-Φ30	55	60.2	46
750	30"	167	646	499	86	F25	300	254	8-φ18	965	900	24-Φ30	55	60.2	46
800	32"	190	672	513	85	F25	300	254	8-φ18	1015	950	24-Φ33	55	60.2	46
900	36"	203	720	563	118	F25	300	254	8-φ18	1115	1050	28-Φ33	75	72.2	55
1000	40"	218	800	628	130	F25	300	254	8-φ18	1230	1160	28-Φ36	85	72.2	55
1050	42"	251	825	740	150	F25	300	254	8-φ18	N/A	N/A	N/A	85	72.2	55
1100	44"	254	825	740	128	F25	300	254	8-φ18	1340	1270	32-Φ36	95	72.2	55
1200	48"	254	940	844	150	F30	350	298	8-φ22	1455	1380	32-Φ39	105	98.2	75