

STRAINER Y-TYPE

FAF 2500

2500



Features

- Y-Type strainer is used for filtering the mass particles inside the flow through the steel filter chamber situated in the body.
- Straining is accomplished with an internal mesh lined straining element, the size of which should be determined based on the size of the smallest particle to be removed. Recommended for installation upstream of control valves.
- Double filter Construction avoids water hammer effects.
- By removing the cover placed on the body, detailed cleaning can be performed or filter can be replaced. Quick removal of lid for maintenance.
- The hole diameters on the filters are determined in order to have a minimum effect on the head loss and flow rate.
- According to request, the hole diameters of the filters can be manufactured in different dimensions.
- Inner and outer surfaces of the Y-type strainer are coated with fusion bonded powder epoxy (FBE) optionally with industrial epoxy.
- DN 15-DN 200 Filter size: 20 Mesh.
- DN 250- DN 400 Filter size: 40 Mesh.
- Filter mesh size can be changed according to request.
- Plug MS58 BRASS.
- Stock piled for quick delivery.

Temperature

- +200 °C

PRODUCTION STANDARDS

DN15 → DN400
PN 10-16

Connection	EN 1092-2 / ISO 7005-2 - Flanged
Face to Face	EN 558 Series 1 / DIN 3202 F1 / TS 11494
Marking	EN 19
Tests	EN 12266-1
Corrosion Protection	Electrostatic Powder Epoxy

Product Description

FAF2500 Y-Strainers are installed in a piping system to remove unwanted debris from the pipeline, protecting expensive equipment downstream such as pumps, meters, spray nozzles, compressor, and turbines. They can be placed in a horizontal or vertical pipeline as long as the screen is in a downward position.

Versions

- Standard version
- Custom production for specific orders
- Fusion bonded epoxy (FBE) coating
- Industrial Epoxy coating

Spare Parts

- Stainless steel filters
- Sealing Gasket

Scope of Application

- Chamber installation
- Installation in plants
- Pipelines
- Water treatment plants
- Pumping stations
- Tanks, reservoirs
- Seawater applications
- Power plants (cooling water pipelines)
- Industry

STRAINER Y-TYPE FAF 2500

2500

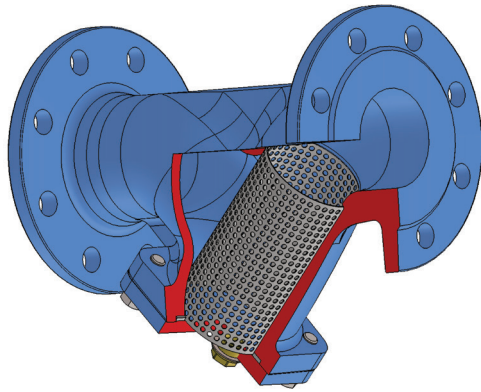

MATERIAL SELECTION

Body EN-GJS-500 DUCTILE IRON / GGG50

Filter 1.4301 - AISI 304 Stainless Steel

Plug MS 58 - Brass

VALVE TEST PRESSURE (Bar)

MAX. OPERATING PRESSURE	BODY / SHELL TEST	SEAT TEST
10	15	11
16	24	17,6

100% of the valves are subjected to hydrostatic tests at FAF facilities.

Note

- For proper use and safety precautions please follow the installation and operating instructions.

Material List

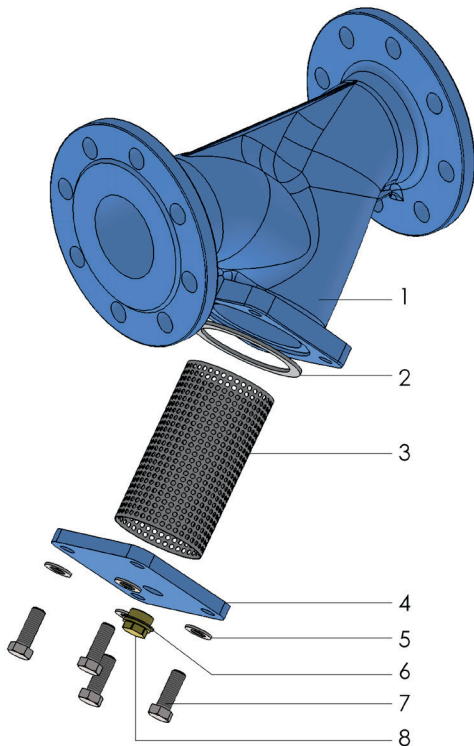

NO	ITEM	MATERIALS
1	BODY	EN-GJS-500 DUCTILE IRON
2	SEALING GASKET	KLINGERITE
3	FILTER	1.4301 STAINLESS STEEL
4	COVER	ST 37 STEEL
5	WASHER	DIN 125
6	CIRCLIP	DIN 472
7	BOLTS	DIN993
8	NUT	CuZn40Pb2 BRASS

STRAINER Y-TYPE

FAF 2500

Technical Details & Drawing, Dimensions

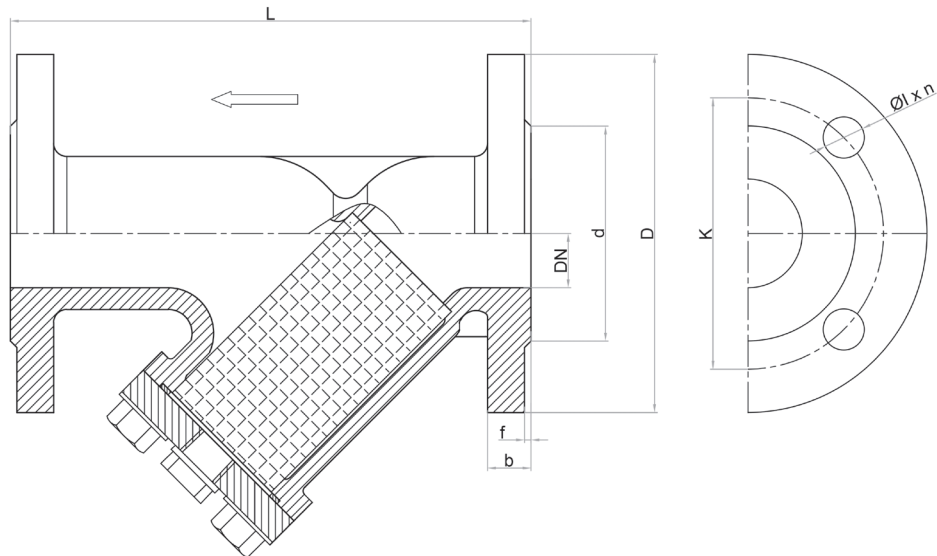

DN (mm)	D	K	d	Øl x n	f	b	L	Weight (kg)
15	95	65	46	14x4	2	14	130	1,9
20	105	75	56	14x4	2	16	150	3
25	115	85	65	14x4	3	16	160	4
32	140	100	76	19x4	3	18	180	5,8
40	150	110	84	19x4	3	18	200	7,6
50	165	125	99	19x4	3	20	230	10,3
65	185	145	118	19x4	3	20	290	14,4
80	200	160	132	19x8	3	22	310	18,8
100	220	180	156	19x8	3	24	350	22,7
125	250	210	184	19x8	3	26	400	34,5
150	285	240	211	23x8	3	26	480	50
200	340	295	266	23x12	4	30	600	89,5
250	405	355	319	28x12	4	32	730	166
300	460	410	370	28x12	4	32	850	196
350	520	470	429	28x16	4	36	980	225
400	580	525	480	31x16	4	38	1100	318